

881.541.11 - 981.541.11

SOLID SURFACE CUT AND PLUG REPAIR SET



Congratulations on your new purchase!

This manual will assist you during the use of your new set. This manual is not intended to teach you about working materials. This is basic information for use of our product. It is assumed that you are a professional and you are familiar with the basic material working skills and techniques necessary to use this product safely. If you are unsure after reading all material presented in the manual, please consult widely available books on material working techniques.

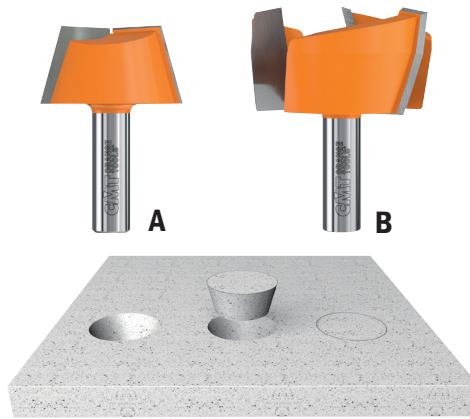

Read and understand the entire contents of this manual before attempting assembly or operation of these tools! Inspect contents for shipping damage and shortages. Report problems to your distributor immediately.

General Conditions

CMT reserves the right to make product changes without notice and without obligation to make these changes on products previously sold. Title and risk of loss or damage to the goods passes to the buyer upon consignment to the carrier regardless of who pays the shipping cost.

CMT is not liable for damages to goods, property, or persons, due to improper installation or misapplication of equipment.

SAFETY WARNINGS

Failure to heed all safety instructions and warnings regarding use of this product can result in serious bodily injury or death.

- Carefully read all important safety instructions in the owner's manual that came with your machine before operating.
- If you do not have a manual, contact the manufacturer and obtain one before using any CMT bits or blades.
- Always wear eye protection in compliance with the current ANSI standard Z87.1 when operating any power tool.
- Always use proper guards and other safety devices when operating any machine.
- Carefully check router bits or blades prior to each use. Do not use if damage or defect is suspected.
- Do not exceed recommended RPM for any saw blade or router bit.
- Avoid wearing loose clothing or jewelry that may catch in a rotating saw blade or router bit.
- Unplug the machine when mounting or adjusting any saw blade or router bit.
- For best results always have router bits and saw blades professionally sharpened.

SPECIFIC ROUTER BIT SAFETY PRECAUTIONS

- Never force the bit or overload the router.
- Be sure that at least 3/4 of the shank length is inserted into the router collet.
- Never "bottom-out" the bit in the collet, the end of the shank should be about 3mm (1/8") from the bottom of the collet.
- Always make sure that the guide fences on your router table are firmly clamped in position before each use.
- Route in two or more passes when large amounts of stock must be removed.
- Use reduced speeds for large diameter bits.

HOW TO USE

Safety tips

- **Don't exceed 10,000 RPM when working with this bit set.** Work very slowly and at a steady speed.
- In order to avoid injuries and to obtain precise repairing, secure your router by using some clamps, or, for instance, by gluing scrap wood (image 1-2-4-6), so your machine does not move. In this way you will achieve better results.
- When making the plug, make sure to clamp the surface out of which this will be made.

1 Use router bit "A" to make a hole into the surface to repair (image 3-5) by following the safety tips mentioned above.



2 Keep in mind the safety tips mentioned above and use router bit “B” to make the plug to fit into the previously-made hole. For your safety do not bore the surface completely, otherwise the router will propel the plug away, damaging it on the edges and causing bodily injury. To make the plug adjust the cutting length by leaving about 1-2mm (1/16”) of material on the bottom (image 9). After making the plug (image 7-8), remove it by manually breaking the part not milled (image 10). The plug will have to protrude by 1-2mm (1/16”) than the surface to repair (image 11), so the largest plug diameter will have to be larger than the largest hole diameter.

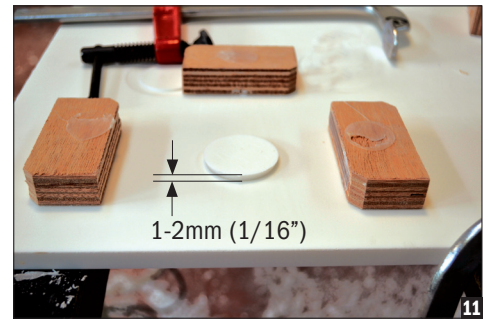
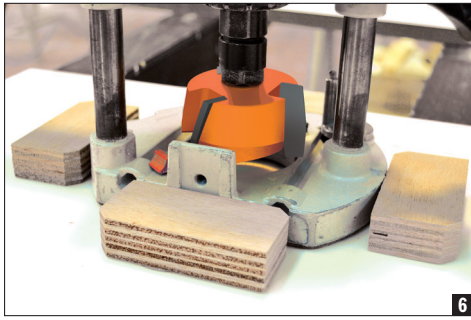

3 Apply some glue on the plug to place into the previously-made hole and secure it by using a vice, so it perfectly adheres (image 12-13-14).

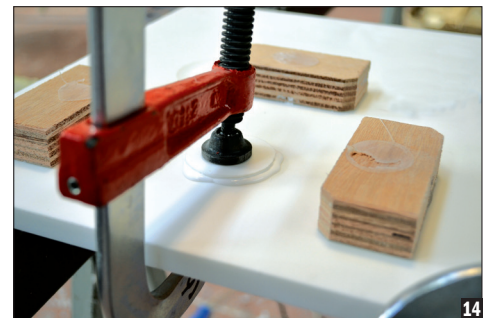
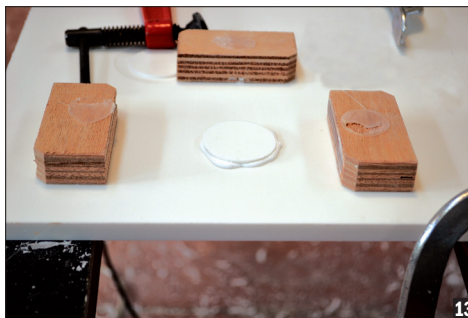

4 After glue has dried, use a sander to remove all extras to make an even surface (image 15). Finally polish the entire surface (image 16).



C.M.T. UTENSILI S.p.A.

Via della Meccanica - 61122 Pesaro - Italia
 Phone #39 0721 48571 - Fax #39 0721 481021
 info@cmtorangetools.com
www.cmtorangetools.com

CMT USA, Inc.

7609 Bentley Road Suite D - Greensboro, NC 27409 USA
 phone 336.854.0201 - toll-free 1.888.268.2487
 fax 336.854.0903 - free-fax 1.800.268.9778
 infocmtusa@cmtorangetools.com
www.cmtorangetools.com

03.60.0330

©: CMT, the CMT logos, CMT ORANGE TOOLS and the orange color applied to the tool surfaces are trademarks of C.M.T. Utensili S.p.A.

© C.M.T. UTENSILI S.P.A.

This document has been sent for your personal use only.

All usage and reproduction is forbidden without written permission from C.M.T. UTENSILI S.P.A.

